

Bitterne Manor Park

This map is based upon Ordnance Survey material with the permission of Ordnance Survey on behalf of the Controller of Her Majesty's Stationary Office © Crown copyright. Unauthorised reproduction infringes Crown copyright and may lead to prosecution or civil proceedings. Southampton City Council 100019679 2010

Client: **SCC**

Scale: **NTS**

Title: **Final rev**

Project:
**Bitterne Manor
Park
Options**

Date **6.11.9**

Designer
CB

Drawn by
CB

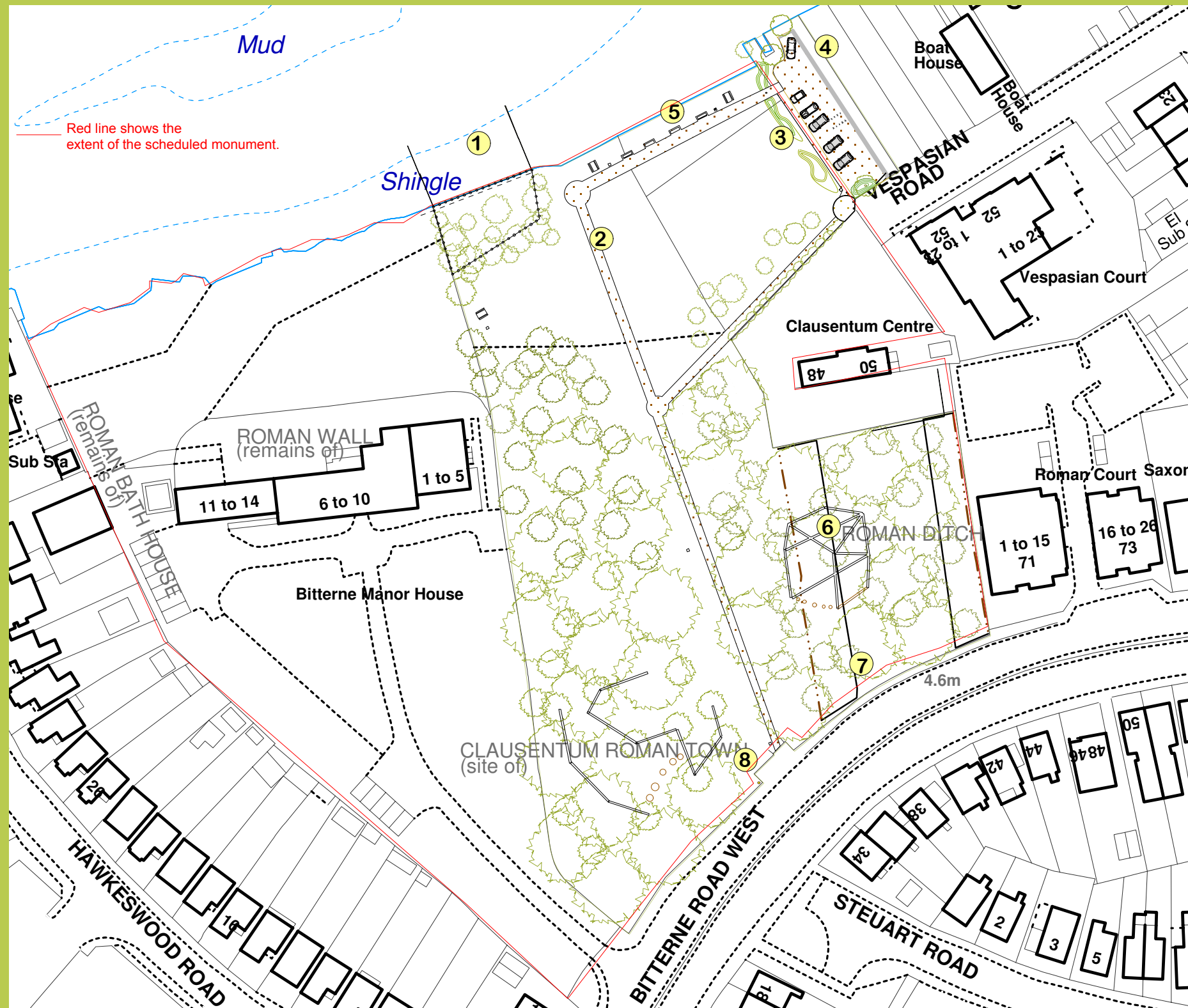

1. Enclosed wildlife area protects a section of beach from visitors and dogs.

2. The gravel paths are long and straight to echo the areas Roman heritage. Emphasises the view from Bitterne Road.

3. Bunding to prevent unauthorised vehicular entry.

4. Car Park with bunding to control vehicular access onto the park. Litter bins.

5. Picnic benches,

6. Informal play such as fallen trees and timber in the woodland.

7. Sycamore thicket thinned leaving the best trees to mature and to allow underplanting with native bulbs

8. The existing entrance restored to it's original design, with additional Park Identity Marker.